

Retrofit Apron Front Farm Sink With Dual Mount Capability Installation Instructions

— For Top-Mount Use Only —

For Under-Mount Installation please refer to page 14

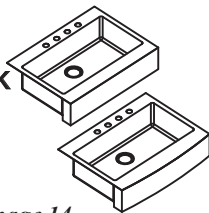

FOR EXPERIENCED AND PROFESSIONAL INSTALLATION ONLY

This installation project is designed for an advanced skill level.

Disclaimer: Undermount Application must use a modified sink base and solid surface countertop material.

IMPORTANT! The countertop must be flat. This sink will not install to countertops with integral drip edges.

*Your countertop thickness cannot exceed 1-1/2" (38 mm).

*Your countertop cannot overhang the cabinet face more than 1-1/2" (38 mm).

*Your countertop must be fully supported by the cabinet.

*Proper installation requires a coordinated effort including advanced dialog between the designer (or customer), the cabinet maker, the countertop fabricator and the sink installer during the design and installation phase.

***BEFORE INSTALLING THE SINK, INSPECT IT FOR DAMAGE. DO NOT INSTALL A DAMAGED UNIT.**

CAUTION: Risk of personal injury. Metal surfaces are sharp and can cause severe cuts. Please use gloves and handle sink with care.

* These instructions provide 2 different installation methods: new countertop installation and replacement.

Follow the instructions that apply to your installation method.

* Inspect the drain and supply lines; replace if necessary.

*** Remember it is your responsibility to follow all local plumbing and building codes.**

The warranty will be voided if these installation instructions are not followed.

Tools Needed



Tape Measure



Waterproof Wood Glue



Safety Glasses



Painter's Tape



Felt-tip Marker



Laminate Jigsaw Blade



Scissors



Saw



Sandpaper



Silicone Sealant



Utility Knife



Level



Flat Screwdriver



Square



Hand Wood Saw

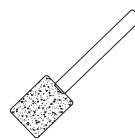

Foam-Brush

Retrofit Apron Front Farm Sink With Dual Mount Capability Installation Instructions

— For Top-Mount Use Only —

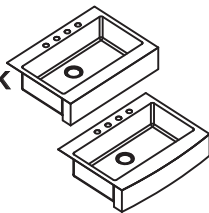

Before You Start

Please complete this check list.

This sheet is designed to assist you in making an informed decision on the selection of your retrofit apron front farm sink. Please answer the following questions to determine whether your current kitchen cabinet can use this style of sink.

1). Is your countertop flat?

The countertop must be flat to assure a proper installation.

Please Note – Countertops with a “No Drip” edge will not work with this sink application.

YES NO

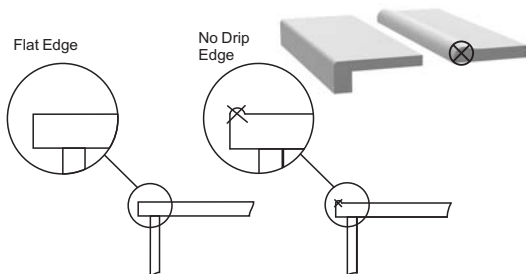

2). Is your sink base cabinet 36" wide?

YES NO

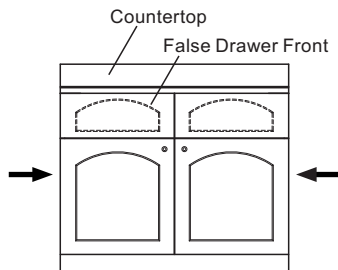

3). Does your cabinet have false drawer fronts?

(Some have one large false drawer front and some have 2 false drawer fronts)

YES NO

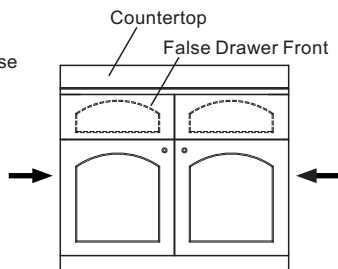

Retrofit Apron Front Farm Sink With Dual Mount Capability Installation Instructions

— For Top-Mount Use Only —

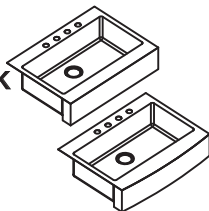

4). Is the dimension between the cabinet styles 33"?
(This measurement is the open space from left to right when the false drawer front is removed)

YES NO

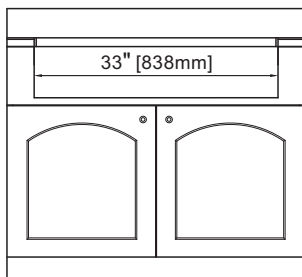

5). Measure the distance from the top of the door rail and the top of the cabinet.
This will determine the apron height of the sink you can choose.
Add 1-1/2" to the measurement (this is the typical countertop height).
the total will tell you which sink to choose.

Please Note – Typical Cabinet height from the rail to the top of the cabinet is 6" or 6 1/2". If 6" - (6" + 1 1/2" = 7 1/2" Apron Height is required), if 6 1/2" (6 1/2" + 1 1/2" = 8" Apron Height required).

7- 1/2" – Flat apron Front
8" - Curved Apron Front

Please Note – a 7 1/2" Flat Front sink can be used for an 8" Height, for this application you will need to place a trim strip under the sink to cover the 1/2" opening. (not included)

Measurement

Measurement + 1-1/2"

Total

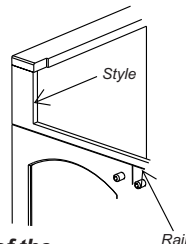

If you have answered yes to these questions you can choose one of the Apron front farm sinks listed below for your kitchen.

Model Number	Description	Apron Height
482-6515	33" x 24" x 7-1/2" 60/40 Double Bowl	7-1/2"
482-6516	33" x 24" x 7-1/2" Single Bowl	7-1/2"
482-6517	33" x 24" x 7-1/2" 50/50 Double Bowl	7-1/2"
482-6518	33" x 25" x 8" 60/40 Double Bowl	8"
482-6519	33" x 25" x 8" Single Bowl	8"
482-6520	33" x 25" x 8" 50/50 Double Bowl	8"

Retrofit Apron Front Farm Sink With Dual Mount Capability Installation Instructions

— For Top-Mount Use Only —

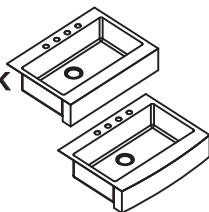

1. Prepare the Cabinet - Replacement of an Existing Sink

- Please remove the false fronts (two small or one large panel) please be careful not to damage the cabinet front.

- Apply painter's tape to the cabinet front, this will help prevent damaging the surface when cutting out the drawer fronts.

- If the cabinet has a center support (if you have two smaller false fronts you will have a center support) please remove it at this time. Cut along the bottom even with the drawer opening making sure you do not cut into the cabinet.

- Please remove the top rail, being careful not to cut into the cabinet styles.

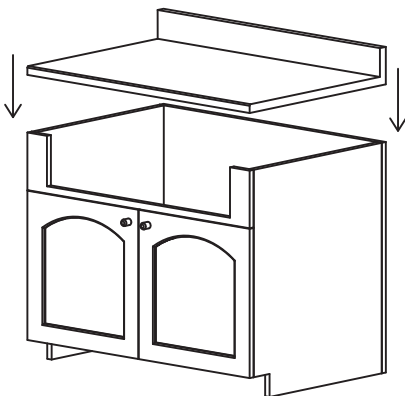

2. Preparing Your Countertop

If you have a New Countertop Installation please refer to page 9.

- Put the painter's tape at the centerline of the cabinet from front the backsplash to the front edge of the countertop.

- Put the painter's tape across the front edge of the countertop along the entire width of the sink base cabinet.

- Mark the centerline of the cabinet onto the painter's tape.

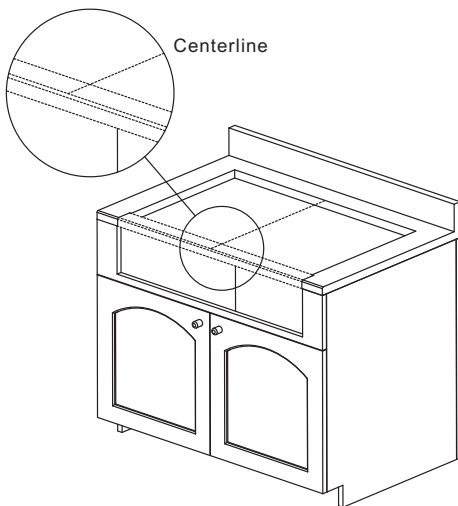

Retrofit Apron Front Farm Sink With Dual Mount Capability Installation Instructions

— For Top-Mount Use Only —

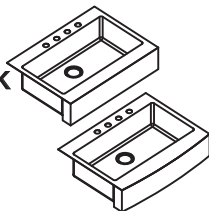

3. Trace the Template

- Cut out the paper template along the top mount marked line.

- Cut out the diamond on the template this will help you line up the centerline, it should be in the center of the diamond.

- Please put painter's tape to all exposed outside edges prior to securing the template in place. This will help prevent chipping when cutting.

- Put the template on the countertop. Line up the template with the lines marked on the painter's tape over the pre-existing hole.

- Mark the 2 notches from the template 1-15/16" from the edge of the countertop.

- Tape the template in place.

- Trace the template on the applied painter's tape.

- Trace the notches at the front of the template.

- Remove the template

- Put painter's tape to the front of the countertop to prevent chipping the laminate when cutting.

- Extend the marked lines down the front of the countertop onto the painter's tape.

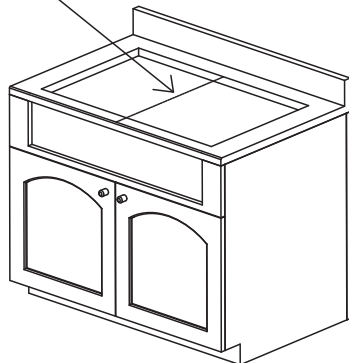
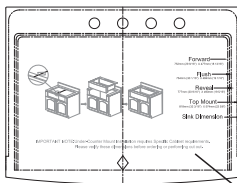

Retrofit Apron Front Farm Sink With Dual Mount Capability Installation Instructions

— For Top-Mount Use Only —

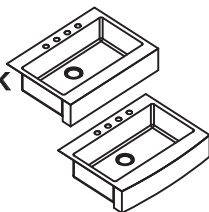

4. Cut the Countertop

IMPORTANT! To avoid damage to the cabinet surfaces, cut the countertop in the order of the steps below.

NOTE: If your existing sink hole is set back close to the backsplash you will need to adjust the depth of the notch.

This will allow you to slide the sink back further to get a tight fit.

TIP: To prevent chipping the laminate, put painter's tape to the edge of the countertop before cutting.

TIP: Make sure your equipment is in good working order and your blades are sharp to ensure a smooth installation and straight cuts.

1. Using the laminate saw blade cut the countertop along the inside marked line.

2. Carefully cut away from the cutout to the end of the marked line. Be careful not to damage the cabinet face.
Repeat this step on the other side.

3. Carefully cut the marked notch out, cut in from the edge of the countertop and intersect it with the marked notch. Be careful not to damage the cabinet face.

Repeat this step on the other side.

TIP: Please use sand paper to smooth all cut edges.

- Lower the sink carefully into the countertop opening to make sure it fits, do not force it. The fit will be tight. If the opening is too small please recheck your dimensions.

4. Very Important - Spread a generous amount of waterproof wood glue on both notches to seal the newly exposed wood. This will help to make this area water resistant and keep water from penetrating into the wood and swelling the underlayment. Please wipe away any excess glue.

TIP: Please wipe away any excess glue.
Please allow the wood glue to dry completely.

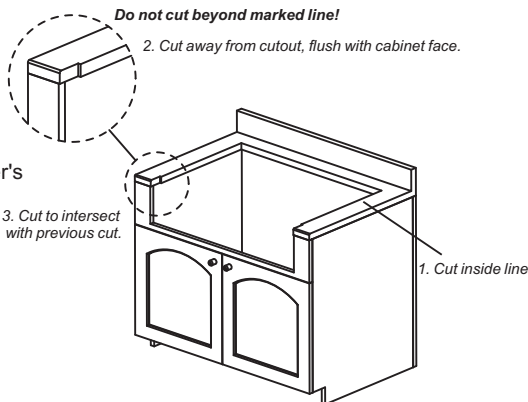

Retrofit Apron Front Farm Sink With Dual Mount Capability Installation Instructions

— For Top-Mount Use Only —

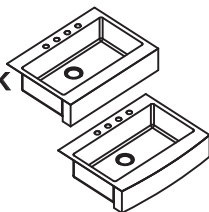

5. Install the Sink

- To protect the cabinet finish, temporarily apply painter's tape around the cabinet cutout.
- Apply a bead of silicone around the cutout.
- Carefully lower the sink into the cabinet.
- Be sure to wipe away any excess silicone sealant.

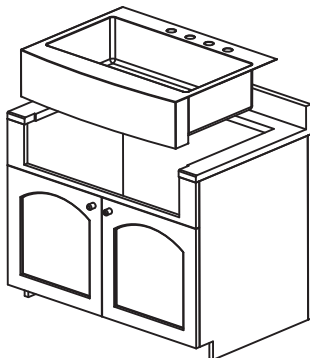

6. Install the clips from under the cabinet.

- Slide three clips into either side of the back rail of the sink.
- Slide two clips into each side rail of the sink.
- Evenly space the clips.
- Assemble the screws into the U channel fasteners as shown.

NOTE: Screws are designed to insert into the channel fasteners with backward threading, so that when mounting they will turn in a counter-clockwise direction.

- Locate the fasteners in the position as shown.

- Hand tighten each fastener onto the channel so that the clamp "teeth" point in the same direction as the U channel. To install U channel fasteners in channel bar: Slide U channel fasteners in channel bar from either open end and /or slots in channel.

A. Place U channel fasteners equally spaced and with one at each end of channel bar, hand tighten channel fasteners, starting at the center and working toward sides.

B. Position the fasteners claw under the top edge as shown. Locate the fastener in position as shown.
Caution: Improper tightening of channel fasteners could result in improper installation or cause damage to sink.

C. Re-check sinks position on countertop.

D. Tighten all channel fasteners an additional quarter turn with a flat head screwdriver.

IMPORTANT! DO NOT OVERTIGHTEN.

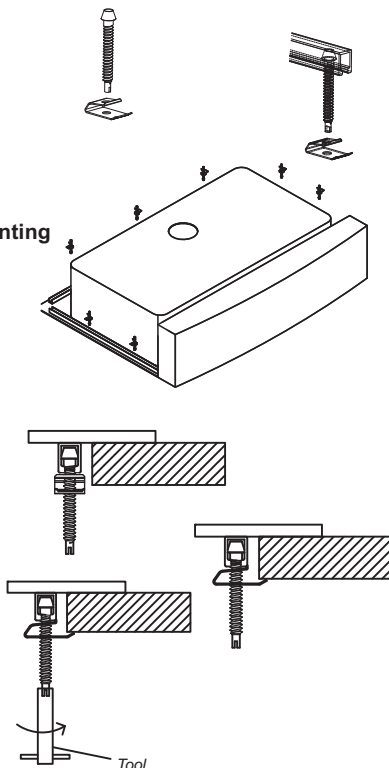

Retrofit Apron Front Farm Sink With Dual Mount Capability Installation Instructions

— For Top-Mount Use Only —

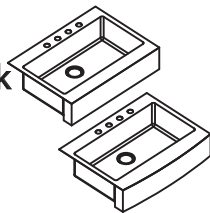

7. Finishing the Installation

- Apply silicone sealant around the edge of the sink, be sure to completely cover the notched area where the countertop meets the apron front sink.

- Wipe away excess before it dries.

- Install the faucet and drain per manufacture's installation instructions.

Note: To add a finishing touch to your new sink you can add a furring strip around the apron.
(please check to make sure the cabinet doors have clearance to accept a furring strip.)

Retrofit Apron Front Farm Sink With Dual Mount Capability Installation Instructions

— For Top-Mount Use Only —

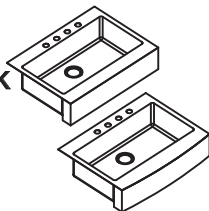

1. Preparing Your Cabinet

- Please remove the false fronts (two small or one large panel) please be careful not to damage the cabinet front.

- Apply painter's tape to the cabinet front, this will help prevent damaging the surface when cutting out the drawer fronts.

- If the cabinet has a center support (if you have two smaller false fronts you will have a center support) please remove it at this time. Cut along the bottom even with the drawer opening making sure you do not cut into the cabinet.

- Please remove the top rail, being careful not to cut into the cabinet styles.

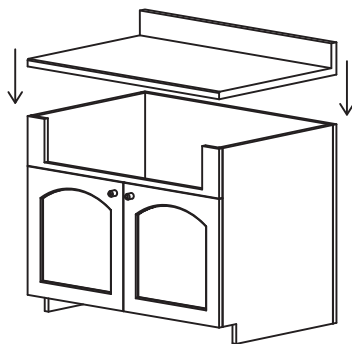

2. New Countertop Installation

It is very important that you check to make sure your countertop is compatible with this retrofit apron front farm sink.

Your countertop thickness cannot exceed 1-1/2" (38mm)

Your countertop cannot overhang the cabinet face more than 1-1/2" (38mm).

Your countertop must be fully supported by the cabinet. If it is not please shim the countertop as needed. Ensure the countertop is fully supported along the entire depth of the cabinet.

- Install the countertop per the manufacturer's instructions

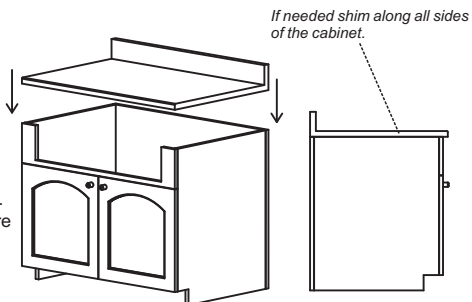

Retrofit Apron Front Farm Sink With Dual Mount Capability Installation Instructions

— For Top-Mount Use Only —

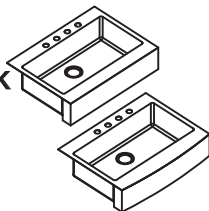

3. Preparing Your Countertop

- Put the painter's tape at the centerline of the cabinet from front to backsplash to the front edge of the countertop.
- Put the painter's tape across the front edge of the countertop along the entire width of the sink base cabinet.
- Mark the centerline of the cabinet onto the painter's tape.

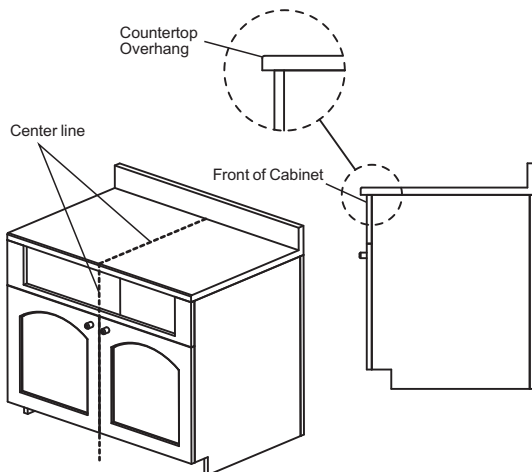

4. Trace the Template

- Cut out the paper template along the Top Mount marked line.
- Cut out the diamond on the template this will help you line up the centerline, it should be in the center of the diamond.
- Please put painter's tape to all exposed outside edges prior to securing the template in place. This will prevent chipping when cutting.
- Put the template on the countertop. Align the template with the lines marked on the painter's tape.
- Mark the 2 notches from the template 1-15/16" from the edge of the countertop.
- Tape the template in place.
- Trace the template on to the painter's tape.
- Trace the notches at the front of the template.
- Remove the template
- Put painter's tape to the front of the countertop to prevent chipping the laminate when cutting.
- Extend the marked lines down the front of the countertop onto the painter's tape.

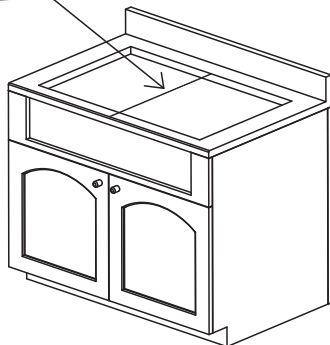
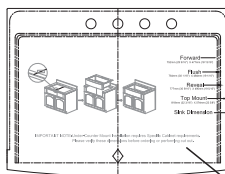

Retrofit Apron Front Farm Sink With Dual Mount Capability Installation Instructions

— For Top-Mount Use Only —

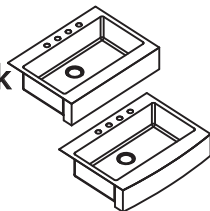

5. Cut the Countertop

IMPORTANT! To avoid damage to the cabinet surfaces, cut the countertop in the order of the steps below.

TIP: To prevent chipping the laminate, put painter's tape to the edge of the countertop before cutting.

TIP: Make sure your equipment is in good working order and your blades are sharp to ensure a smooth installation and straight cuts.

1. Using the laminate saw blade cut the countertop along the inside marked line.

2. Carefully cut away from the cutout to the marked notch line. Be careful not to damage the cabinet face. Repeat this step on the other side.

3. Carefully cut in from the edge of the countertop to intersect with the previous cut. Be careful not to damage the cabinet face.

Repeat this step on the other side.

TIP: Please use sand paper to smooth all cut edges.

- Lower the sink carefully into the countertop opening to make sure it fits, do not force it. The fit will be tight. If the opening is too small please recheck your dimensions.

4. Very Important - Spread a generous amount of waterproof wood glue on both notches to seal the newly exposed wood. This will help to make this area water resistant and keep water from penetrating into the wood and swelling the underlayment. Please wipe away any excess glue.

TIP: Please wipe away any excess glue.
Please allow the wood glue to dry completely.

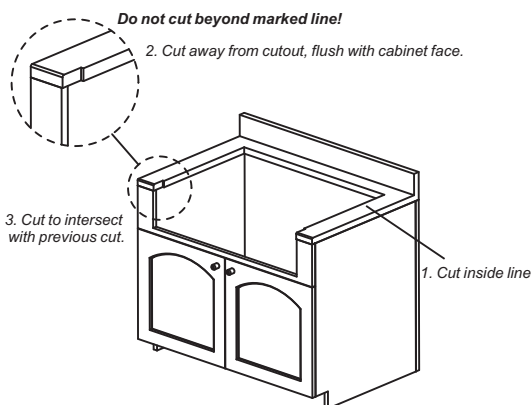

Retrofit Apron Front Farm Sink With Dual Mount Capability Installation Instructions

— For Top-Mount Use Only —

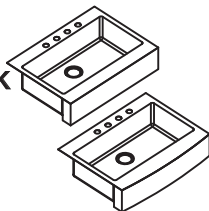

6. Install the Sink

- To protect the cabinet finish, temporarily put painter's tape around the cabinet cutout.
- Apply a bead of silicone around the cutout.
- Carefully lower the sink into the cabinet.

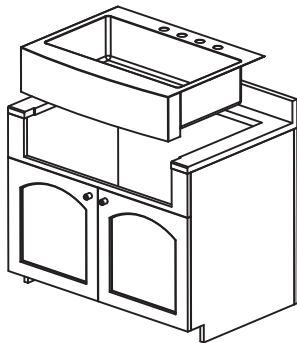

7. Install the clips from under the cabinet

- Slide three clips into either side of the back rail of the sink.
- Slide two clips into each side rail of the sink.
- Evenly space the clips.
- Assemble the screws into the U channel fasteners as shown.

NOTE: Screws are designed to insert into the channel fasteners with backward threading, so that when mounting they will turn in a counter-clockwise direction.

- Locate the fasteners in the position as shown.

- Hand tighten each fastener onto the channel so that the clamp "teeth" point in the same direction as the U channel. To install U channel fasteners in channel bar: Slide U channel fasteners in channel bar from either open end and /or slots in channel.

Position the fasteners claw under the top edge as shown.

Locate the fastener in position as shown.

CAUTION: improper tightening of channel fasteners could result in improper installation or cause damage to sink.

- A. Place U channel fasteners equally spaced and with one at each end of channel bar, hand tighten channel fasteners, starting at the center and working toward sides.

- B. Re-check sinks position on countertop.

- C. Tighten all channel fasteners an additional quarter turn with a flat head screwdriver.

IMPORTANT! DO NOT OVERTIGHTEN.

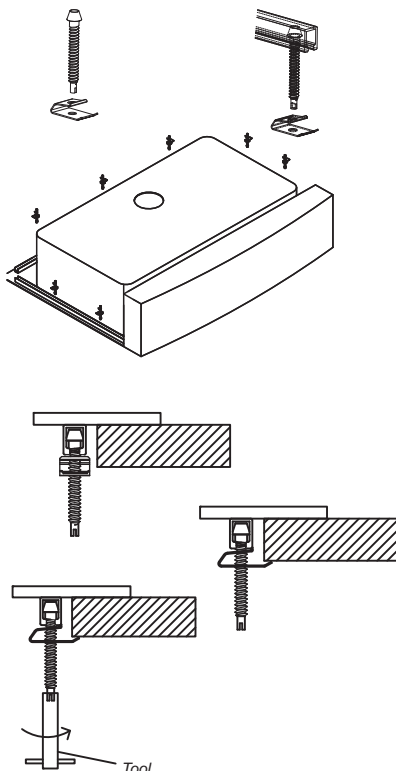

Retrofit Apron Front Farm Sink With Dual Mount Capability Installation Instructions

— For Top-Mount Use Only —

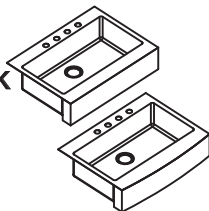

8. Finishing the Installation

- Apply silicone sealant around the edge of the sink, be sure to completely cover the notched area where the countertop meets the apron front sink.

- Wipe away excess before it dries.

- Install the faucet and drain per the manufacture's installation instructions.

NOTE: To add a finishing touch to your new sink you can add a furring strip around the apron (please check to make sure the cabinet doors have clearance to accept a furring strip)

Retrofit Apron Front Farm Sink With Dual Mount Capability Installation Instructions

— For Under-Mount Use Only —

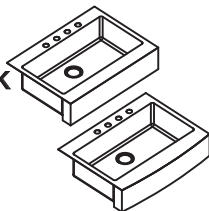

Under-counter Mount Instructions

Caution: Please Read All Instructions Before Beginning The Installation.

Before You Begin

- Metal edges may be sharp use caution when handling.
- For Experienced and Professional Installation only.
- Follow all local standards and codes.
- For solid surface countertop installations only ie: granite, quartz, stone etc.
- A custom sink base cabinet is required.
- Proper installation requires a coordinated effort including advanced dialog between the designer (or customer), the cabinet maker, the countertop fabricator and the sink installer during the design and installation phase.
- Providing the cabinet maker with the actual sink to be installed prior to cabinet fabrication is recommended.

Installation Options:

Please select the right installation option depending on your design.

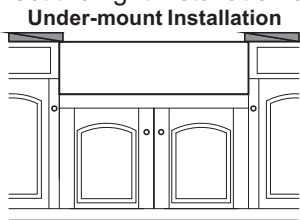

Figure 1

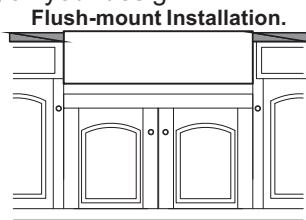

Figure 2

Step 1.

Position template on countertop. Locate the template front to rear, so that sink will not interfere with the cabinet.

Step 2.

Trace a line around the template. Cut along the inside of this line to provide opening. This size opening will provide approximately an 1/8" over hang of counter-top.

Step 3.

Locate and drill the mounting holes (following the counter-top) manufacturer's instructions) as shown below. Holes should allow even spacing of mounting brackets around the sink. Type of fasteners to be as recommended by counter-top supplier.

Retrofit Apron Front Farm Sink With Dual Mount Capability Installation Instructions

— For Under-Mount Use Only —

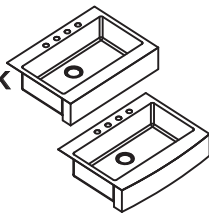

Step 4.

Fasten mounting brackets to counter-top loosely.

Step 5.

Using a good quality silicone sealant, apply a bead evenly all around the top of the sink flanges.

Step 6.

Position and align sink over the counter-top opening. Press silicone onto counter-top.

Step 7.

Tighten fasteners until mounting brackets are snug against sink.

Step 8.

Check alignment of sink counter-top opening.

Step 9.

Tighten down fasteners evenly. Be careful not to overtighten. Remove excess silicone.

Stainless Steel Sink Care:

After Each Use:

- Remove all objects from sink.
- Clean with light soap solution, rinse and drain all water and towel dry.

Regular maintenance:

Side Walls and Bottom of Sink: Remove stains using a cleaning product that contains mild abrasives; always wipe in grain finish. Pay careful attention to the directional change.

Mineral Deposits:

Use a cleaning product that contains mild abrasives or a light solution of vinegar and water(1:20 ratio); rinse well and towel dry.

CAUTION: Stainless steel requires exposure to air; DO NOT leave items, objects, cloths, mats, water, pots, pans, cast irons, knives, etc., in the sink when not washing.

DO NOT:

- Use steel wool or other metal or coarse scouring pads.
- Stand on or in sink when cleaning windows, reaching for top shelf, painting, etc.
- Drop heavy objects in sink as this will cause denting.
- Leave water, bleach, other cleaners or chemicals of any type in sink; always rinse sink after any use and dry with towel.
- Use concentrated bleach, always dilute with water and rinse thoroughly after use.
- Use any acids, drain cleaners, harsh chemicals, paint removers, metal cleaners, etc., in sink.
- Drop sharp objects in sink or use as a cutting surface.



Retrofit Apron Front Farm Sink With Dual Mount Capability Installation Instructions

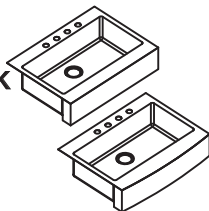

LIMITED LIFETIME WARRANTY

Compass Manufacturing International's Bala Sinks stainless steel sinks are warranted to the original consumer purchaser to be free from defects in material and workmanship for as long as the original consumer purchaser owns the home. Compass Manufacturing International will, at its option, replace or repair, without charge such product if it fails due to a manufacturing defect for a lifetime of normal residential use. Product replacement does not include transportation cost or labor installation cost. This warranty covers only the stainless steel sink installed in a conventional counter-top surface and applies to residential installations only. Compass Manufacturing International reserves the right to examine the product in question and its installation prior to replacement.

LEGAL DISCLAIMER

All technical data and information provided in this publication is done as a public service to customers of Compass Manufacturing International and consumers of our products.

All names, designs and model numbers of products are trademarks of Compass Manufacturing International. Prices and specifications are subject to change without notice or obligation. Compass Manufacturing International also reserves the right to change or discontinue models of its products without notice or obligation. While Compass Manufacturing International endeavors to provide you with accurate information and descriptions of its products, accuracy and completeness can not be guaranteed.

Compass Manufacturing International is not responsible for nor does it have any liability for any mistakes or typographical errors, including liability for incident, consequential, or special damages. All products should be inspected and measured promptly upon delivery and certainly before any improvements or alterations are done in anticipation of or for preparation for installation. Compass Manufacturing International assumes no liability for the use of such information or for any damages incurred through its use or application.

Nothing contained in this publication is to be construed as contractual or providing any form of warranty or representation on the part of Compass Manufacturing International.

Compass Manufacturing International Makes No Warranties, Express or Implied Including But Not Limited To Any Warranty of Merchantability Or of Fitness For A Particular Purpose, As To The Information Contained Herein Or The Products Described Herein.