



Round Front Toilet



MaP Result (Flush)

1000 gram

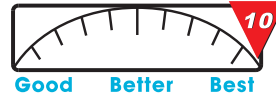

Toilet Seat not Included

	Model	Color
Tank	571-6914	White
Bowl	571-6913	White

Delano HET Round Front 1.28 GPF 3" Flush Toilet

DESCRIPTION

- * 1.28 GPF (4.8 LPF) Siphon Jet Flush
- * 15" (382mm) Rim Height
- * Large Water Surface
- * 2" Wide Fully Glazed Trapway
- * 12" Rough-In
- * Upgraded High Performance Fill and Flush Valve System

Project / Job Name			
Architect / Engineer			
Contractor			
Model		Quantity	
Notes :			



Round Front Toilet

SPECIFICATIONS

- * Water Usage : 1.28 GPF (4.8 LPF)
- * Trap Diameter : 2"
- * Rough-In : 12"
- * Trap Seal : 2"
- * Min. Water Pressure : 28 psi
- * Water Surface : 8-5/8" x 6-7/8"
- * Flush System : Siphon Jet Gravity Flushing System
- * Warranty : Five Year Limited Warranty
Includes One Year Parts Warranty
- * Material : Tank & Bowl: Vitreous China
- * Shipping Weight : Tank: 30.75LBS
Bowl: 43LBS
- * Shipping Dimensions : Tank: 18-1/8" x 9" x 15-3/4"
Bowl: 26" x 9-7/8" / 15-3/4" x 16-5/16"

Round Front Toilet

Model No.: 571-6914 - Tank (White)

571-6913 - Bowl (White)

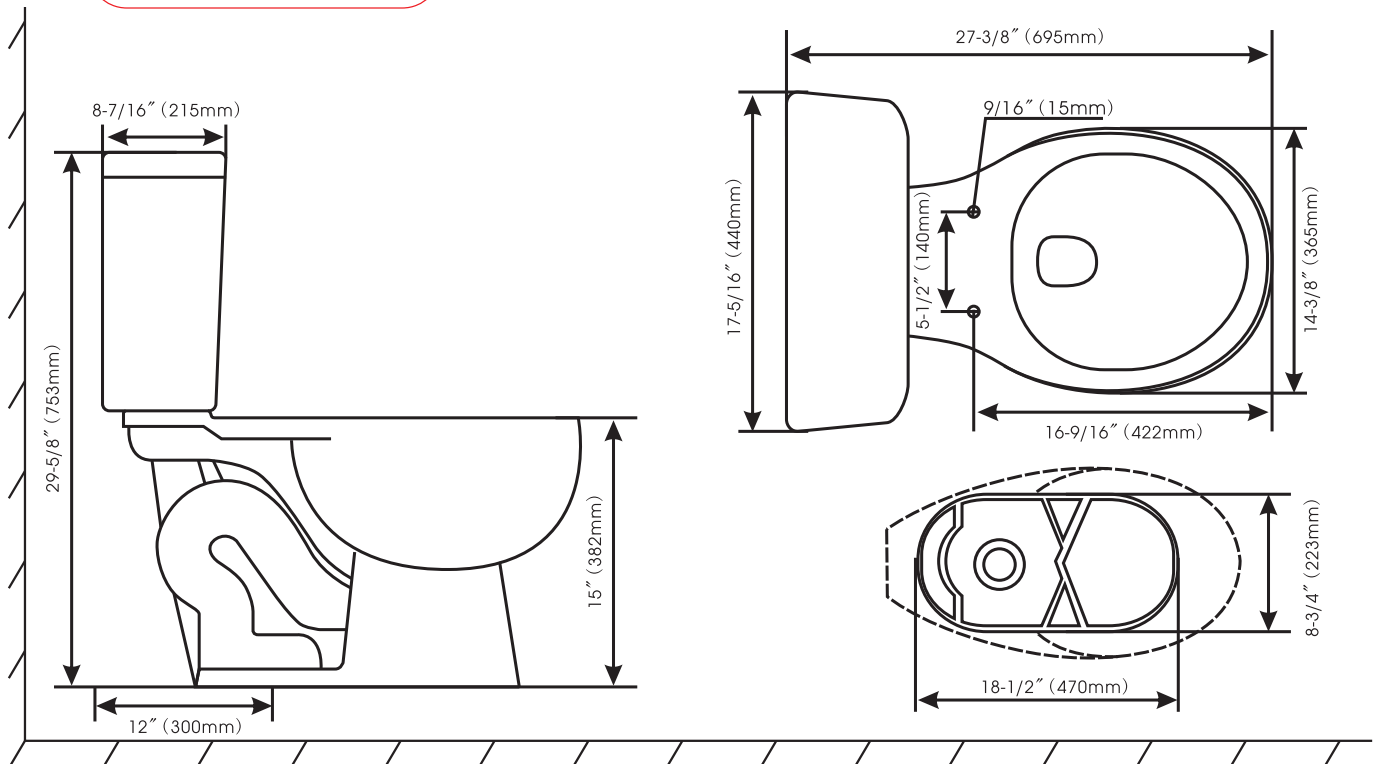

Product dimensions are nominal and may vary within a tolerance in accordance with ANSI Standard 112.19.2. These are subject to change without notice. Compass Manufacturing International has the right to make revisions or corrections without notice to product pages. We assume no responsibility for voided product pages.